

F R E E M A N

AMERICAN CHEMICAL SOCIETY SEPTEMBER 11-13, 2006

MOSCONE CENTER
SOUTH HALL B & C
SAN FRANCISCO, CA

START DATE: 11-14-05 D.B.
Revised: 11-30-05 D.B.

396 - 10X10 BOOTHS = 39600 SQ.FT.
16 - 20X20 BOOTHS = 6400 SQ.FT.
4 - 20X30 BOOTHS = 2400 SQ.FT.
4 - 20X40 BOOTHS = 3200 SQ.FT.
1 - 30X30 BOOTHS = 900 SQ.FT.
1 - 30X40 BOOTHS = 1200 SQ.FT.
TOTAL SQUARE FOOTAGE: 53700 SQ.FT.

FOLSOM STREET

HALL C

EMERGENCY PEDESTRIAN RAMP

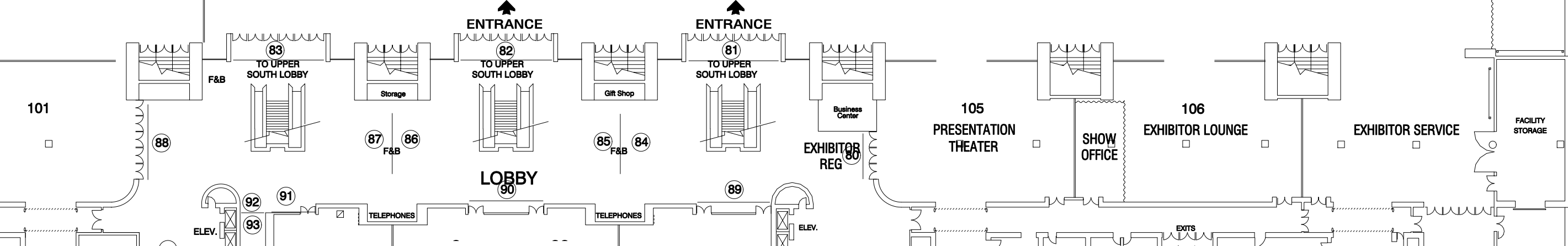
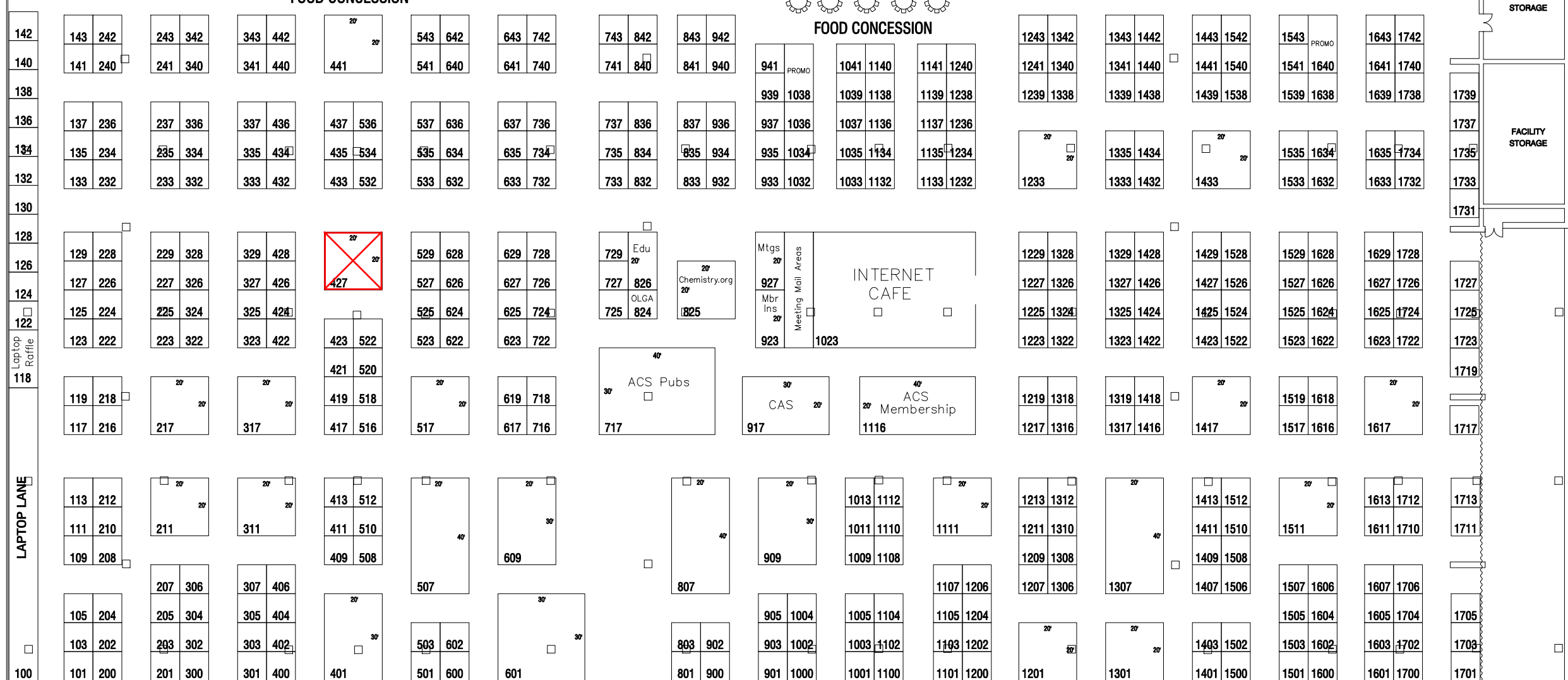
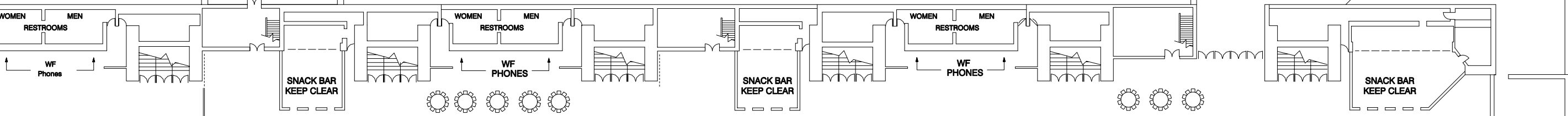

FOURTH STI